

INC. VILLAGE OF ISLAND PARK

LOCAL LAW 9 OF 2016

Fences, Hedges and Walls, is hereby adopted to include the following addition:

- F. All fencing installed in the front yard, from the property line fronting on a street to the front houseline, is to be no more than four (4) feet in height, and be of the type of construction that allows for fifty percent (50%) visibility. (Example: picket or chain link fencing)
- G. Fees
 - Building Permit Filing Fee \$50.00
 - Building Permit Approved \$100.00 for the first \$1,000.00 in construction costs, \$12.00 for every \$1,000.00 additional cost
 - Certificate of Completion Fee \$25.00

FENCE PERMIT APPLICATION INSTRUCTIONS

Application Must Include the Following:

1. Building Permit Application and fee of \$50.00.
2. Two (2) copies of property survey with indication of location of fence.
3. Fence Permit Application and Survey must be approved by Chief Building Inspector.

Requirements:

1. Six (6) foot fences may be erected \pm from the front of the house line to the rear property line of the property.
2. Fences from the property line fronting on a street to the front of the house shall not be more than four (4) feet in height and must be see-through (i.e. chain-link or picket style).
3. Fences on corner property fronting on a street, to the front house line shall not be more than three and a half (3 ½) feet in height and six (6) foot to the rear property line.
4. The finished side of the fence must face away from the property being fenced.
5. Fences may not be erected on a publicly owned land,
6. Fences in commercially zoned areas must conform to setbacks as specified by zoning.

Upon Completion:

1. Schedule a Final Inspection by Inc. Village of Island Park Chief Building Inspector.

Village of Island Park Fence Guidelines

Rear of Residence

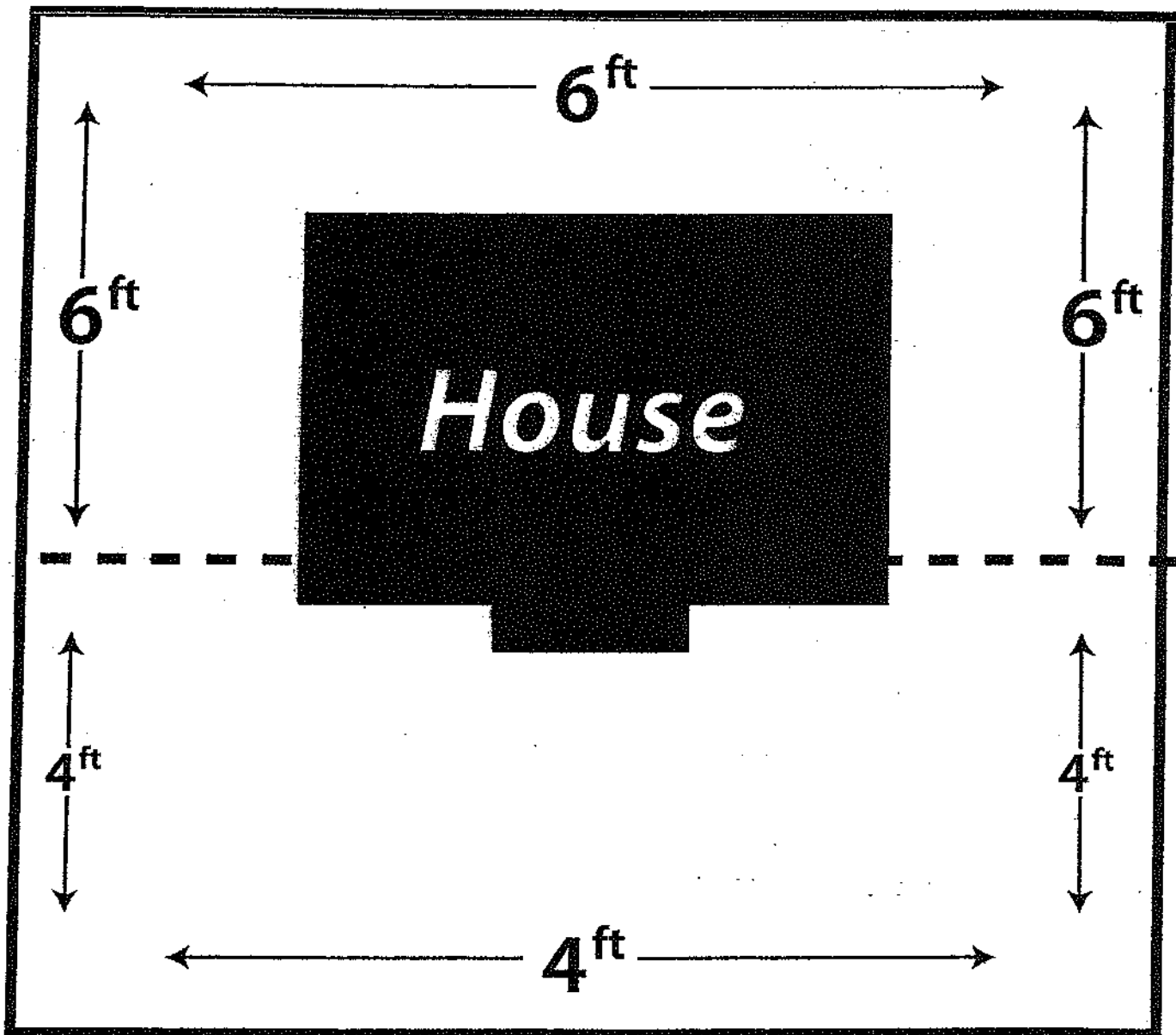

Front of Residence
Street Side

Village of Island Park Fence Guidelines

Corner Properties

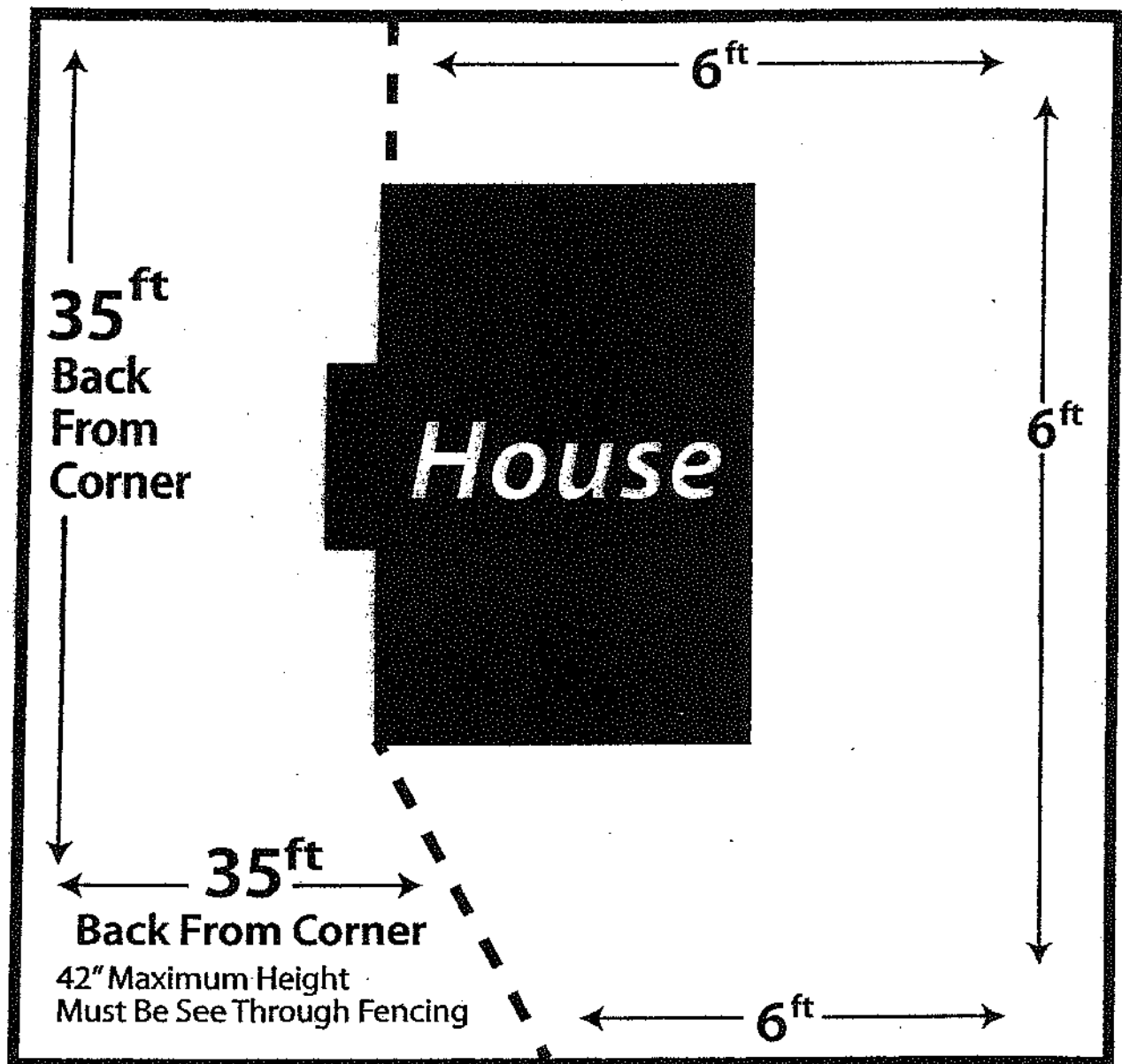

STREET #2
Side